



Design Update

Owatonna New High School



Independent School District #761
Owatonna, MN
February 8, 2020



New High School:

- 1,600 Students
- 317,164 SF
- Spaces included:
 - Classrooms
 - Science Labs
 - FACS
 - Engineering and Technology
 - Art
 - Business
 - Music
 - Media Commons
 - Student Services
 - Physical Education
 - Special Education
 - Student Commons
 - Administration
 - Support Spaces
 - Auditorium
 - Stadium



DESIGN PROCESS CORE PLANNING GROUP

A Core Planning Group typically consists of members that are selected from a cross-section of the users of the facility, including parents, community members, staff, students, and other local stakeholders. The team is charged with the task of seeking input from the broader pool of Input Givers/Input Resources throughout the school district and community to develop the planning criteria.

Meetings :

Dec. 18, 2019

Jan. 15, 2020

Jan. 29, 2020

Feb. 12, 2020

Feb. 26, 2020

March 4, 2020

April 1, 2020

April 22, 2020

September 30, 2020

Core Planning Group Members:

Alyson Bowman
Ann Freeman
Beth Fink
Christian Flores
Dale Phiefer
Denise Lage
Doug Wanous
Isabella Barrie
Istahil Hassan

Jerrold Atkinson
Kelly Rooks
Lauren Gendron
Liban Mohamed
Liz Tinaglia
Liza Drever
Marc Achterkirch
Marilyn Olson
Marv Tjaden

Matt Heers
Matt Skala
Nolan Church
Rachael Bird
Sara Craig
Seth Muir
Steve Benson
Todd Andrix



DESIGN PROCESS PROJECT SUBCOMMITTEES

Performing Arts & Music Subcommittee

Meetings:

Jan. 29, 2020

Feb. 26, 2020

April 8, 2020

April 29, 2020

October 1, 2020

Members:

Cheryl Smith

Chris Harris

Dom Korbel

Erik Eitrheim

Isabelle Townley

Jeff Marks

Julia Christenson

Julie Evers

Justin Winterhalter

Kayla Mollenhauer

Kiara Gentz

Lilly Trager

Marilyn Pederson

Pete Guenther

Ryan Gillespie

Sandra Justice

Sara Baird

Tanner Smith

Wes McMains



DESIGN PROCESS PROJECT SUBCOMMITTEES

Physical Education & Athletics Subcommittee

Meetings:

Feb. 12, 2020

March 3, 2020

April 1, 2020

April 22, 2020

October 1, 2020

Members:

Ashleigh Milbrath

Brian Coleman

Caleb Vereide

Chad Parrish

Greg Sullivan

Hussein Osman

Janessa Moore

Jeff Williams

Jerry Eggermont

Kari Steiskal Olson

Will Halverson

Mark Randall

Maurice Dut

Mike Klein

Molly Froman

Rhynda Dulas

Reid Stansky

Sandy Boss

Scott Seykora

Shannon Vick

Tate Cummins



DESIGN PROCESS

USER GROUP MEETINGS

User Group Meetings

- Started in spring of 2020
- Last rounds were in January 2021
- Met with over 85 users over the course of 125 meetings to discuss the use of their spaces.

That amounts to over 10,000 people-hours of user input to collaborate on the design!

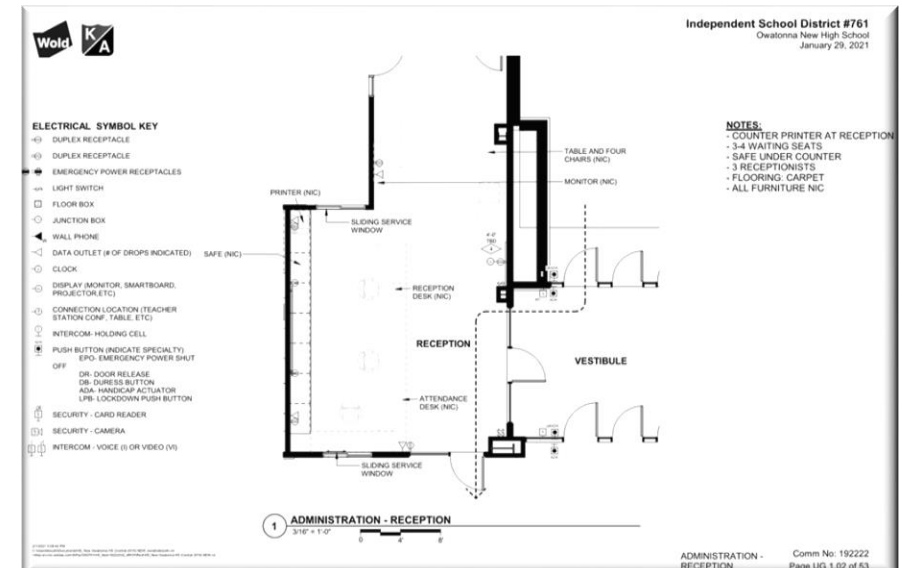



CORE PLANNING GROUP PROJECT COMMITMENTS (1 of 2)

- Putting **students first** is a priority of the design.
- The building and site design will be **welcoming and inclusive** while providing a **safe environment** for all.
- The building will be **efficient, enduring**, and demonstrate the **fiscal responsibility** of our community.
- The building will support a vibrant learning environment that is **innovating, inspiring, and exciting**.
- The building will be **a source of excitement and pride for Owatonna**.
- The design will support learning during the school day, evenings, and weekends.



CORE PLANNING GROUP PROJECT COMMITMENTS (2 of 2)

- The design will create **opportunities for all to succeed** including support for college and career programming and community partnerships.
- The design will include **flexible spaces** to support the educational needs of all students, staff, and the community.
- The building will **maximize spaces to be used by the community**.
- The design will be flexible and provide different types of teaching and learning spaces.
- The design will **accommodate modern technology while remaining flexible and adaptable** for future needs.
- The design will **incorporate natural light** wherever possible and provide a great indoor environment for all occupants.



Owatonna HS Design Concepts

- students first
- welcoming and inclusive
- safe and comfortable environment
- efficient, enduring, fiscal responsibility
- innovating, inspiring, and exciting
- a source of excitement and pride for Owatonna
- opportunities for all to succeed
- flexible spaces
- community use
- foster a sense of community
- learning should be on display
- promotes collaboration
- accommodate student choice
- personalized learning
- foster student ownership over their learning



MAIN
ENTRY

ACTIVITIES
ENTRY





Concept



CITY OF OWATONNA CONCEPT

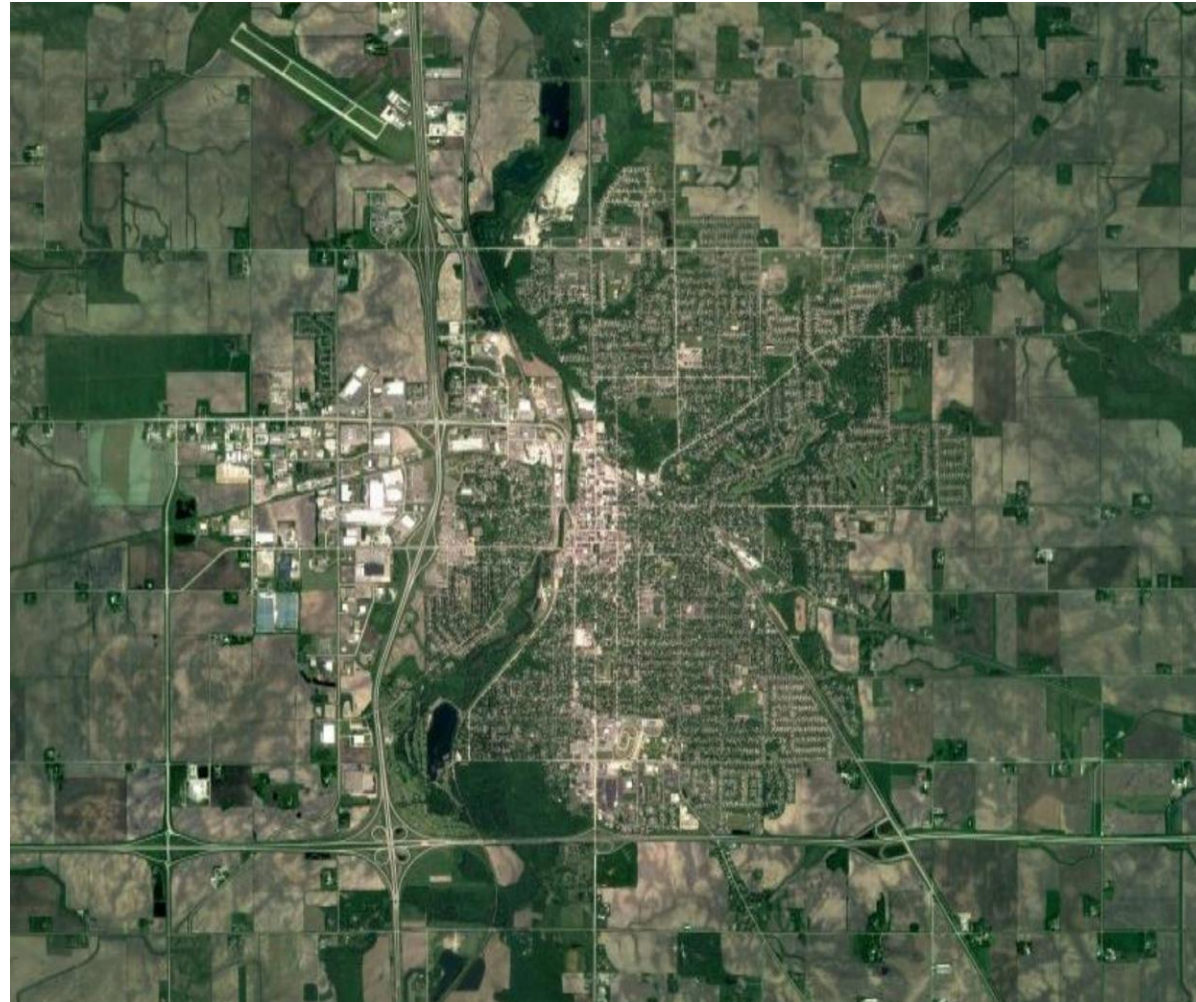



CITY OF OWATONNA CONCEPT

The functions of the city to inform the overall building spatial layout:

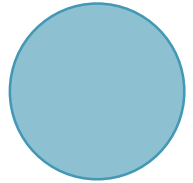

Downtown / River: Commons



Residential: Learning Communities



Commercial: Pathways

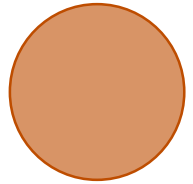

Recreational: Athletics / Performance



Agricultural: Overall Landscape





DESIGN CONNECTION CONCEPT

Commons: River & Downtown

- Embody the colors and textures of downtown
- Apply materials to suggest movement inspired from the river
- Signature learning spaces should be on display from the commons





DESIGN CONNECTION CONCEPT

Residential: Learning Communities

- Incorporate small scale spaces within the Learning Communities
- Create a comfortable and welcoming environment
- Flexible learning areas will be vibrant and full of learning and activity

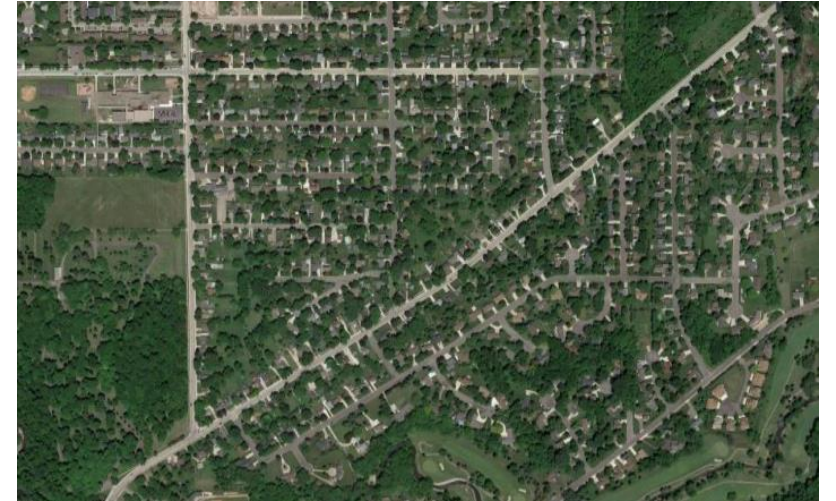



DESIGN CONNECTION CONCEPT

Commercial: Specialized Spaces (Pathways)

- Pathway spaces will create a professional environment for real life experiences
- Manufacturing spaces will provide students access to equipment that they might see in a professional environment.
- These spaces will apply materials and spaces to create the feel of a real world environment.





DESIGN CONNECTION CONCEPT

Recreational: Athletics / Performance

- Utilize natural textures and colors through materials
- Emphasize vertical elements within the building inspired by trees
- Incorporate the ways light filters through nature to help shape how spaces are created

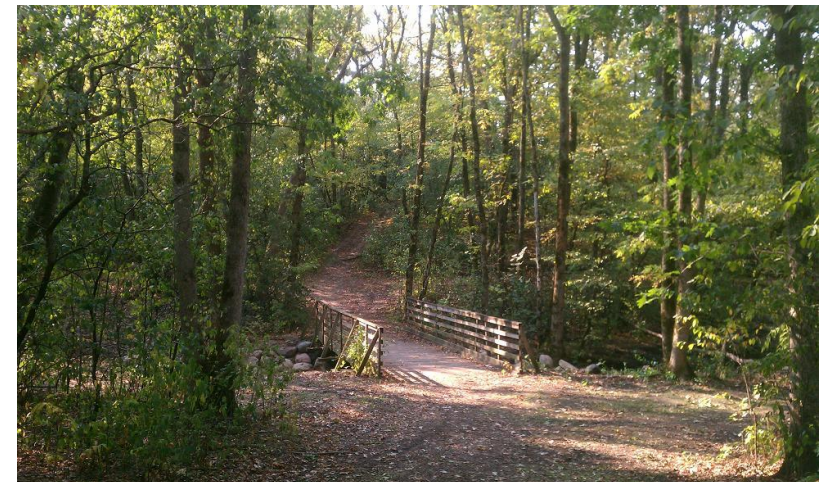



1ST LEVEL FLOOR PLAN

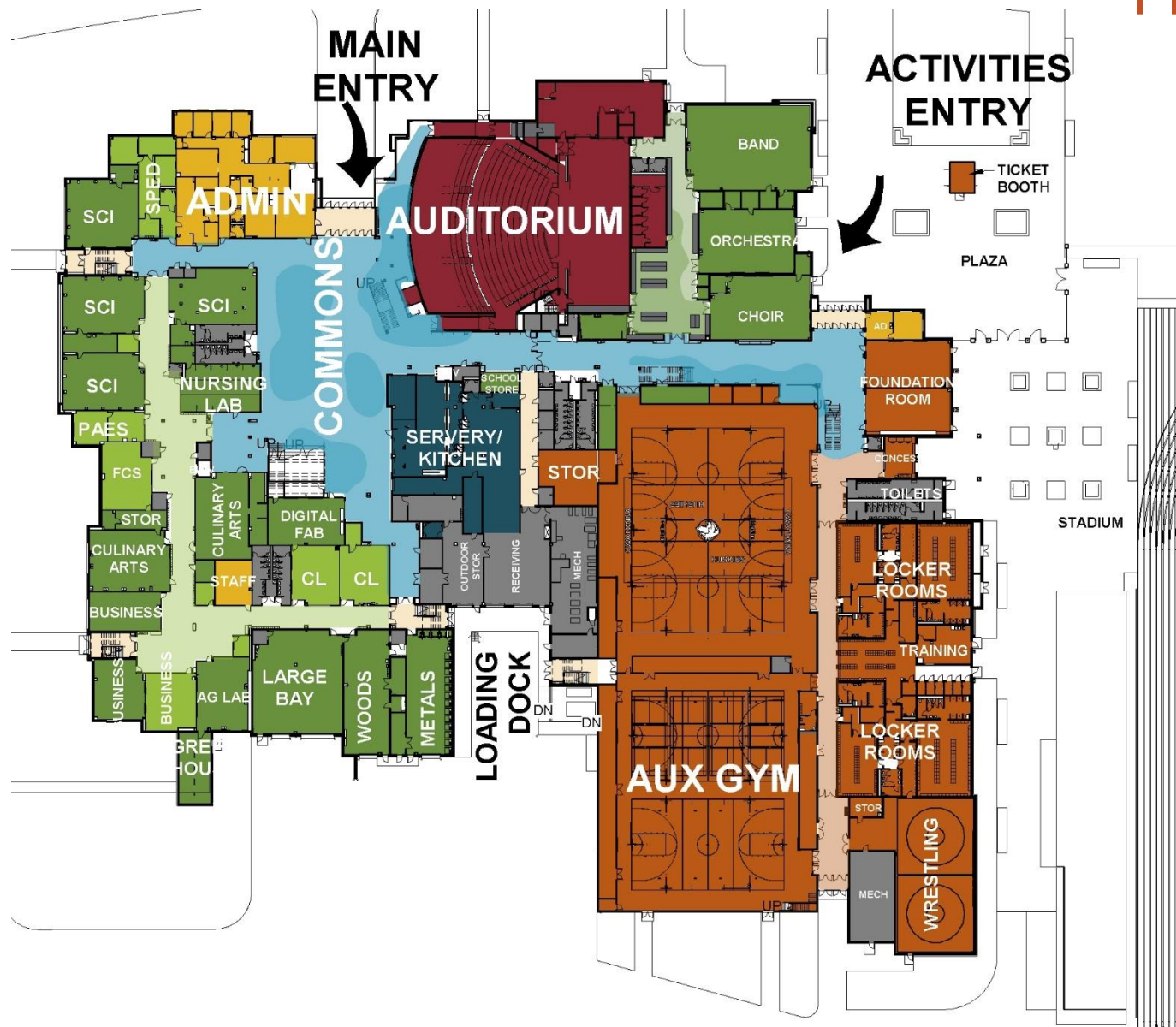



2ND LEVEL FLOOR PLAN





3RD LEVEL FLOOR PLAN







OWATONNA
PUBLIC SCHOOLS
INSPIRING EXCELLENCE • EVERY LEARNER • EVERY DAY



MAIN COMMONS RENDERING

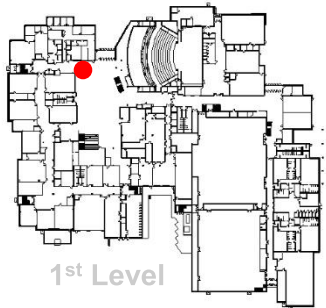
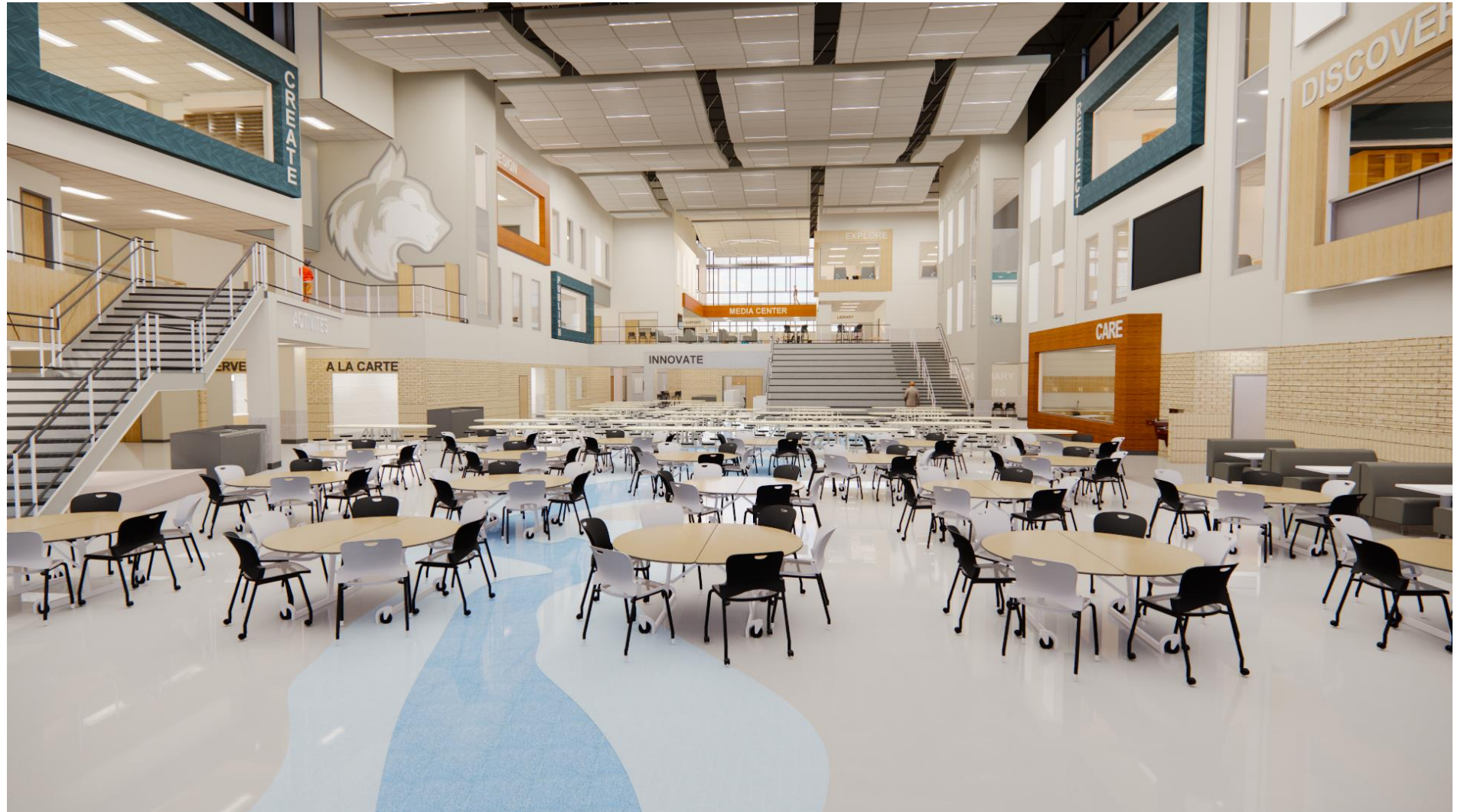

1st Level



OWATONNA
PUBLIC SCHOOLS
INSPIRING EXCELLENCE • EVERY LEARNER • EVERY DAY



BALCONY RENDERING

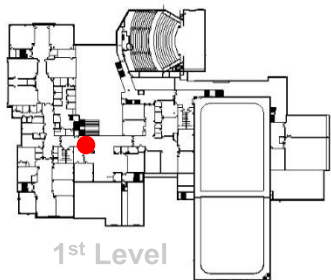

1st Level



OWATONNA
PUBLIC SCHOOLS
INSPIRING EXCELLENCE • EVERY LEARNER • EVERY DAY



MEDIA CENTER RENDERING

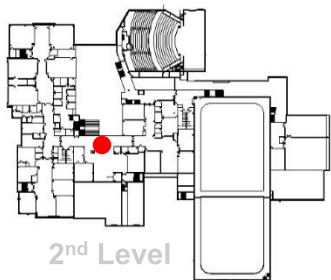

2nd Level



OWATONNA
PUBLIC SCHOOLS
INSPIRING EXCELLENCE • EVERY LEARNER • EVERY DAY



LEARNING COMMUNITY RENDERING

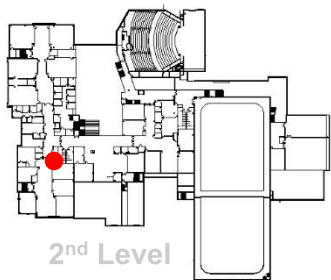

2nd Level



OWATONNA
PUBLIC SCHOOLS
INSPIRING EXCELLENCE • EVERY LEARNER • EVERY DAY



LEARNING COMMUNITY RENDERING

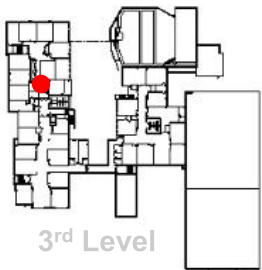



OWATONNA
PUBLIC SCHOOLS
INSPIRING EXCELLENCE • EVERY LEARNER • EVERY DAY



AUDITORIUM ENTRY RENDERING

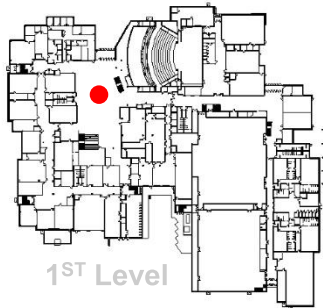



OWATONNA
PUBLIC SCHOOLS
INSPIRING EXCELLENCE • EVERY LEARNER • EVERY DAY



AUDITORIUM INTERIOR RENDERING

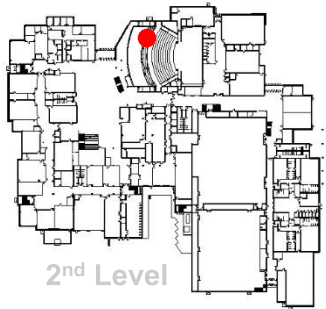

2nd Level



OWATONNA
PUBLIC SCHOOLS
INSPIRING EXCELLENCE • EVERY LEARNER • EVERY DAY



AUDITORIUM INTERIOR RENDERING

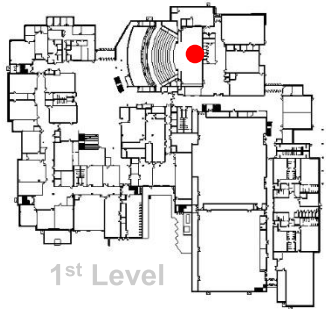

1st Level



OWATONNA
PUBLIC SCHOOLS
INSPIRING EXCELLENCE • EVERY LEARNER • EVERY DAY



AUDITORIUM INTERIOR RENDERING

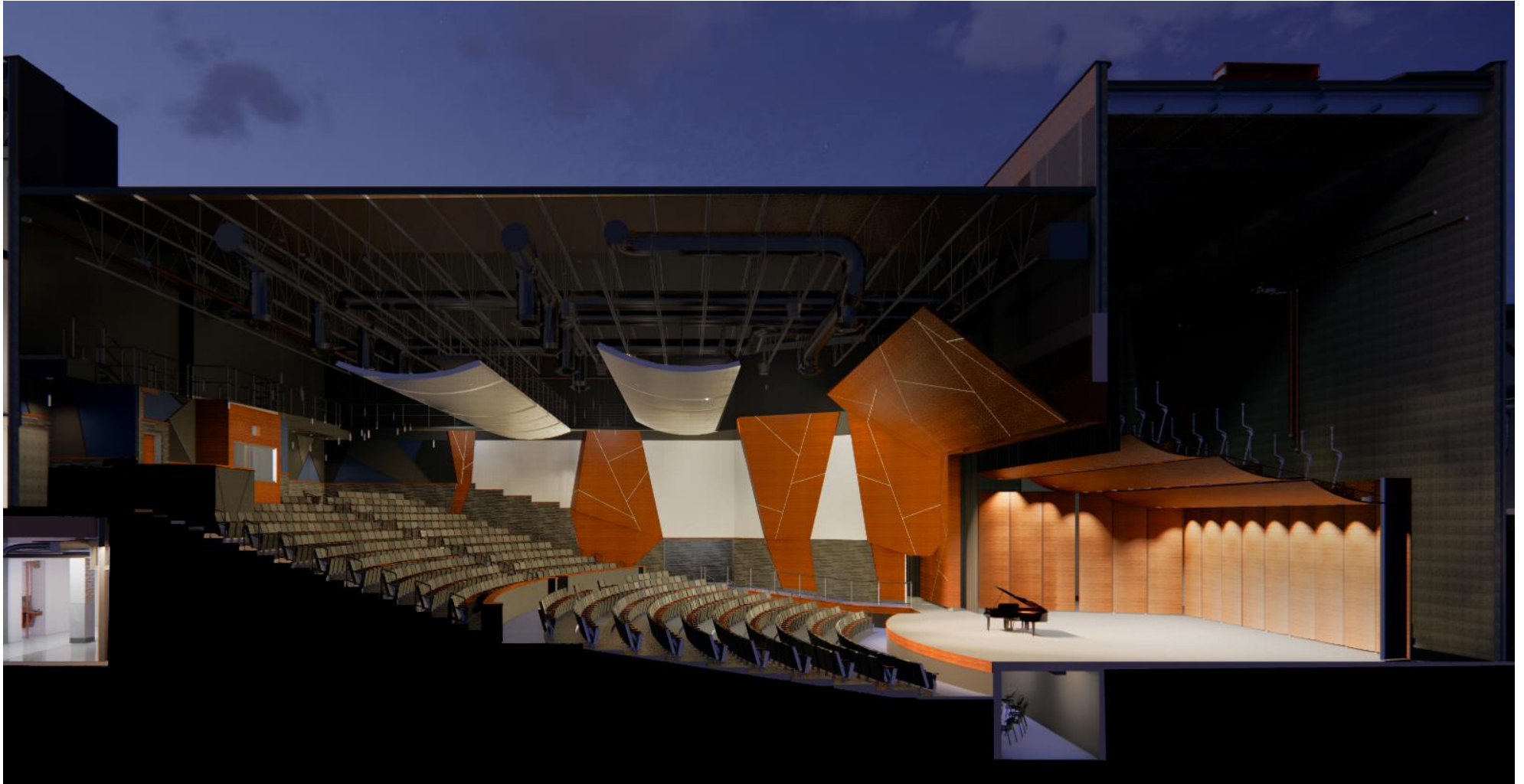
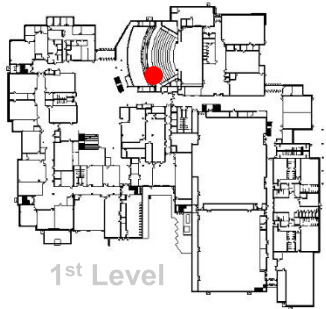



AUDITORIUM INTERIOR RENDERING

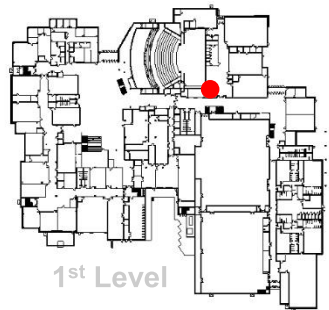

1st Level



OWATONNA
PUBLIC SCHOOLS
INSPIRING EXCELLENCE • EVERY LEARNER • EVERY DAY



AUDITORIUM INTERIOR RENDERING

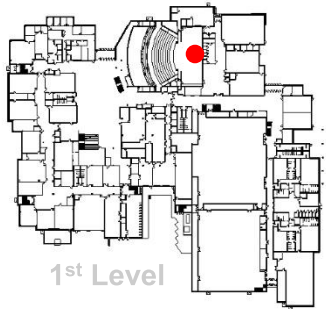

1st Level



OWATONNA
PUBLIC SCHOOLS
INSPIRING EXCELLENCE • EVERY LEARNER • EVERY DAY



AUDITORIUM INTERIOR RENDERING

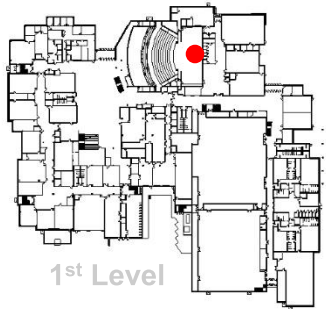

1st Level



OWATONNA
PUBLIC SCHOOLS
INSPIRING EXCELLENCE • EVERY LEARNER • EVERY DAY



ATHLETIC LOBBY RENDERING

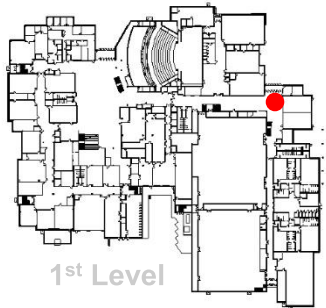



OWATONNA
PUBLIC SCHOOLS
INSPIRING EXCELLENCE • EVERY LEARNER • EVERY DAY



ACTIVITIES HALLWAY RENDERING

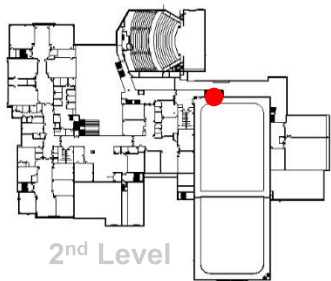



OWATONNA
PUBLIC SCHOOLS
INSPIRING EXCELLENCE • EVERY LEARNER • EVERY DAY



GAME GYM RENDERING

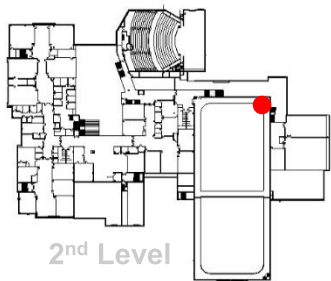

2nd Level



OWATONNA
PUBLIC SCHOOLS
INSPIRING EXCELLENCE • EVERY LEARNER • EVERY DAY



GAME GYM RENDERING

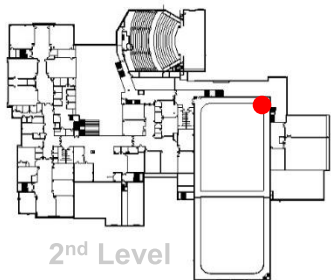

2nd Level



OWATONNA
PUBLIC SCHOOLS
INSPIRING EXCELLENCE • EVERY LEARNER • EVERY DAY



GAME GYM RENDERING

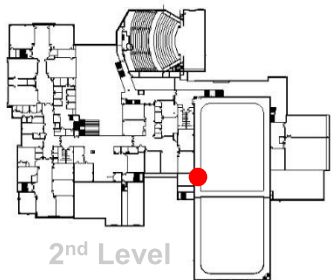

2nd Level



OWATONNA
PUBLIC SCHOOLS
INSPIRING EXCELLENCE • EVERY LEARNER • EVERY DAY



AUX GYM RENDERING

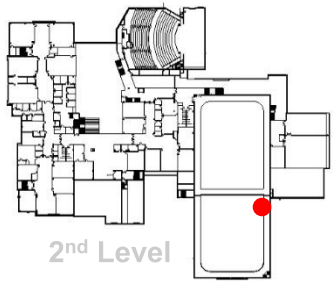

2nd Level



OWATONNA
PUBLIC SCHOOLS
INSPIRING EXCELLENCE • EVERY LEARNER • EVERY DAY



AUX GYM RENDERING

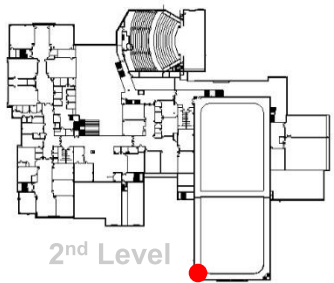

2nd Level



OWATONNA
PUBLIC SCHOOLS
INSPIRING EXCELLENCE • EVERY LEARNER • EVERY DAY



WEIGHT ROOM RENDERING

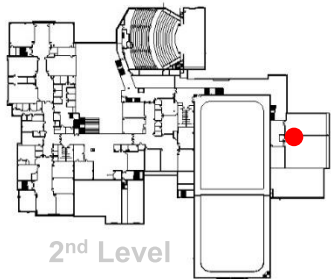

2nd Level



OWATONNA
PUBLIC SCHOOLS
INSPIRING EXCELLENCE • EVERY LEARNER • EVERY DAY



OWATONNA ROOM RENDERING

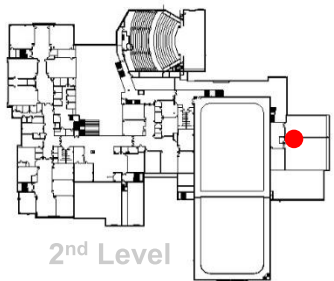



OWATONNA
PUBLIC SCHOOLS
INSPIRING EXCELLENCE • EVERY LEARNER • EVERY DAY



WEIGHT ROOM RENDERING

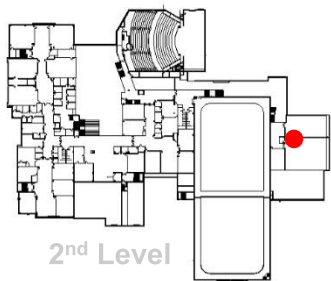

2nd Level



MASSING DIAGRAM

CONCEPT

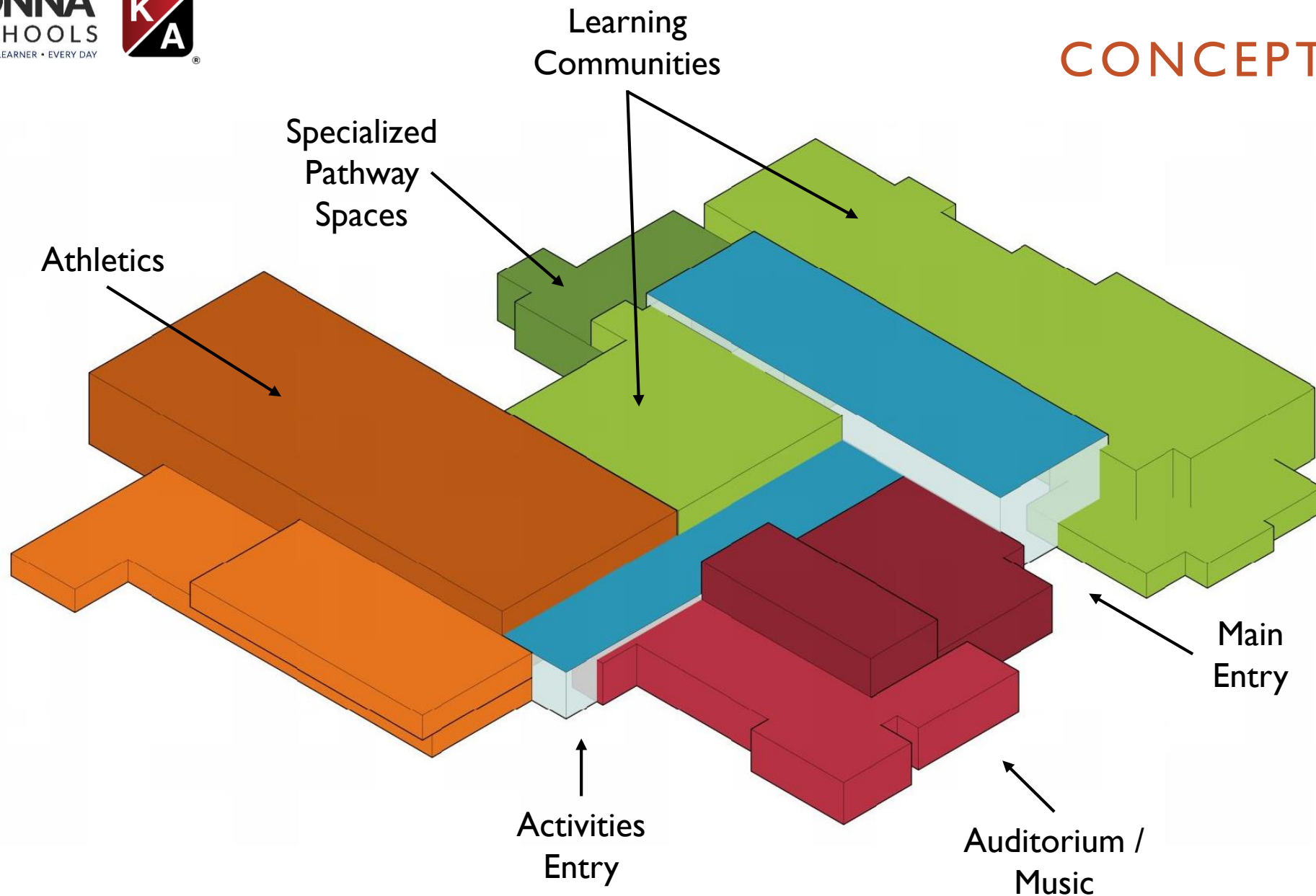



OWATONNA
PUBLIC SCHOOLS
INSPIRING EXCELLENCE • EVERY LEARNER • EVERY DAY



EXTERIOR MAIN ENTRY RENDERING

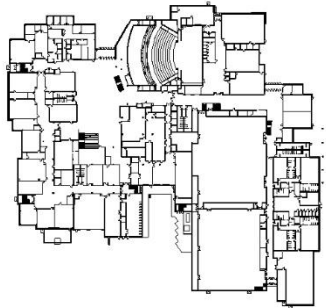



OWATONNA
PUBLIC SCHOOLS
INSPIRING EXCELLENCE • EVERY LEARNER • EVERY DAY



EXTERIOR MAIN ENTRY RENDERING

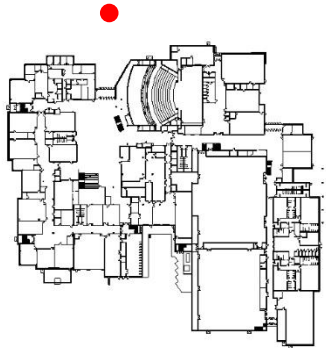



EXTERIOR LEARNING COMMUNITIES

RENDERING

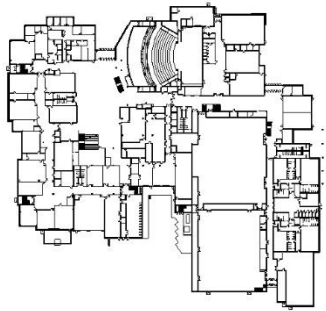



OWATONNA
PUBLIC SCHOOLS
INSPIRING EXCELLENCE • EVERY LEARNER • EVERY DAY



EXTERIOR LEARNING COMMUNITIES

RENDERING

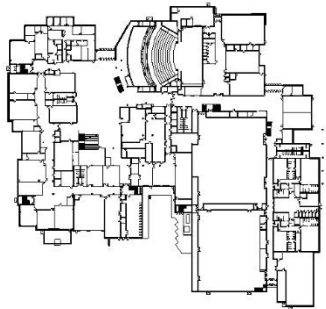



EXTERIOR LEARNING COMMUNITIES

RENDERING

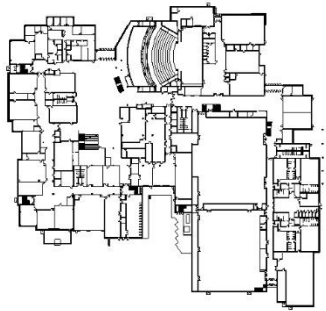



OWATONNA
PUBLIC SCHOOLS
INSPIRING EXCELLENCE • EVERY LEARNER • EVERY DAY



EXTERIOR GYM RENDERING

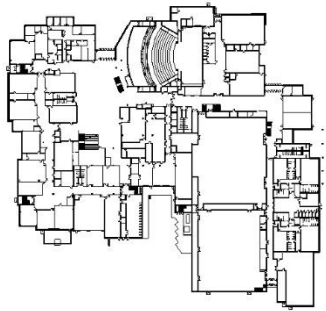



OWATONNA
PUBLIC SCHOOLS
INSPIRING EXCELLENCE • EVERY LEARNER • EVERY DAY



ATHLETIC ENTRY RENDERING

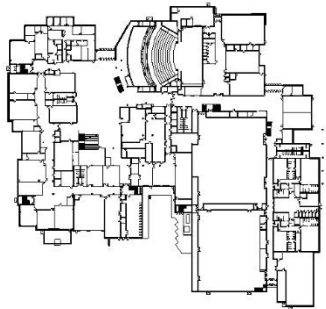



STADIUM PLAZA RENDERING

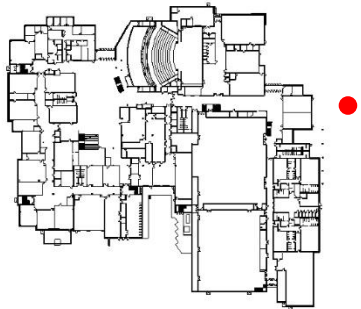



VISITOR BLEACHERS RENDERING

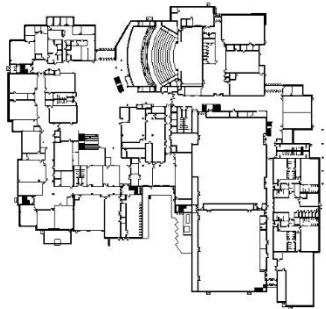



Thank you!